

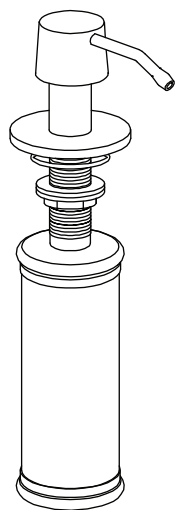

# SOAP DISPENSER

## USER MANUAL



### INTRODUCTION

Thank you for purchasing an authentic Pearl Sinks® soap dispenser. The soap dispenser you have purchased is crafted out of the highest quality nickel, brass and stainless steel. Each and every unit was tested and carefully inspected by hand before delivering to our retailers.

Please read the instructions carefully to prevent any malfunction and damages to your plumbing and property.

### TOOLS

The tools below are required to complete the installation. Some may not be needed depending on the model of the faucet that you are installing. For additional information, check with your local hardware store on the requirements for your installation.



Plumber's Putty



Thread Seal Tape



Flashlight



Channel Locks



Adjustable Wrench



Safety Glasses

### PARTS

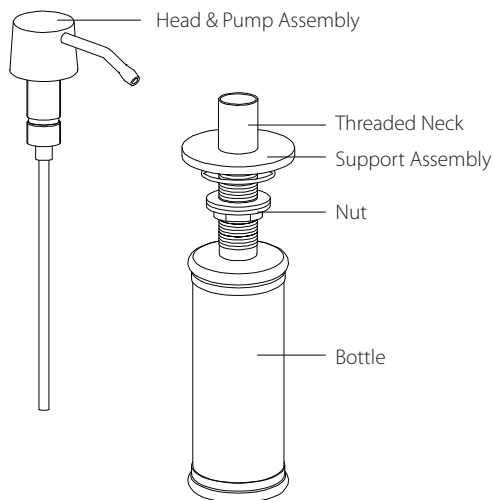

### MOUNTING

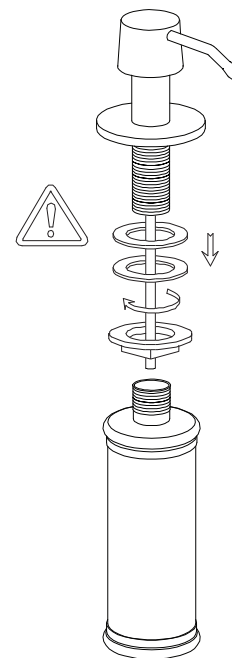

1. Remove the bottle on the bottom by twisting it clockwise. Then remove the nut and washers in the same manner.
2. Place the head and support assembly through the hole. The size of the hole must clear the threaded neck.
3. Put the washer on first, then tighten the nut with channel locks or an adjustable wrench.
4. Attach the bottle to the assembly by twisting the bottle counter clockwise.
5. Make sure that everything is securely attached to the countertop before leaving.

#### HELPFUL HINT:

Always use an adequate amount of plumber's putty or thread sealing tape to prevent connectors or threads from leaking.

### TESTING

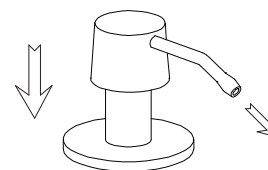

1. Once the soap dispenser is properly installed, fill the bottle with your choice of hand-washing soap or dishwashing detergent.
2. Gently press down on the head pump assembly to dispense its contents.

### MAINTENANCE

Simply rinse the surface of the soap dispenser with clear warm water regularly. For tougher grime rinse with a mild liquid detergent if necessary, then dry the soap dispenser with a clean soft cotton cloth.



Do NOT use any acidic cleaning solutions, abrasive cleaners, or harsh cleaners, as it may damage the natural polish or satin finish of your faucet.

