

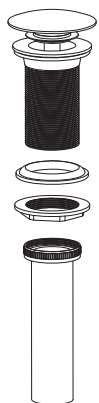

# VANITY STRAINERS

## USER MANUAL



### INTRODUCTION

Thank you for purchasing an authentic Pearl Sinks® vanity strainer. The strainer you have purchased is crafted out of the highest quality nickel and brass. Each and every unit was tested and carefully inspected by hand before delivering to our retailers.

Please read the instructions carefully to prevent any malfunction and damages to your plumbing and property.

This manual covers vessel vanity strainers, conventional undermount vanity strainers with and without overflow. Please find out which model you have before proceeding with installation.

### TOOLS

The tools below are required to complete the installation. Some may not be needed depending on the model of the sink that you have. For additional information, check with your local hardware store on the requirements for your installation.



Plumber's Putty



Thread Seal Tape



Flashlight



Channel Locks



Adjustable Wrench



Safety Glasses

### MAINTENANCE

Simply rinse the surface of the strainer with clear warm water regularly. For tougher grime rinse with a mild liquid detergent if necessary, then dry the strainer with a clean soft cotton cloth.

For harder to reach crevasses and creases, please clean with a soft brush and refrain from using abrasive materials such as scouring pads.



Do NOT use any acidic cleaning solutions, abrasive cleaners, or harsh cleaners, as it may damage the natural polish or satin finish of your faucet.

### HELPFUL HINT:

Always use an adequate amount of plumber's putty or thread sealing tape to prevent connectors or threads from leaking.

### PARTS

Below are the names and terms that may be used in this manual to help identify parts. Some parts are model specific and may not look exactly as illustrated below. Please contact us or consult your nearest hardware store should you have any trouble with the installation.

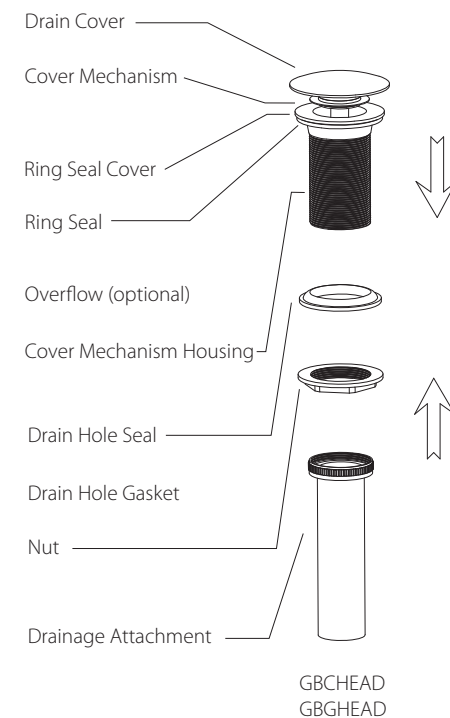

GBCHEAD  
GBGHEAD

### INSTALLATION

1. Put the cover mechanism through the drain hole from the top.
2. Screw on the provided seal ring and nut from the bottom.
3. Attach the drainage attachment to the bottom of the mechanism housing.

### TESTING

1. Once the strainer is properly installed, test it by either pushing down the drain cover or pulling the drain lever to see if all the mechanisms are working properly.
2. Fill the basin with water and test to see if there are any leaks.



PEARLSINKS.COM

